

Download and install the Eyelan app on:

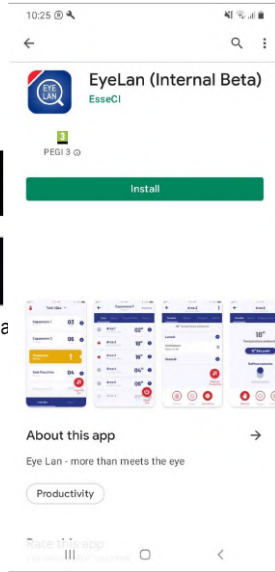

to manage your Qbo termina from smartphone/tablet



Sign up

NOTE: to connect to the dashboard nubesforyou, use the same credentials from any PC connected to the internet

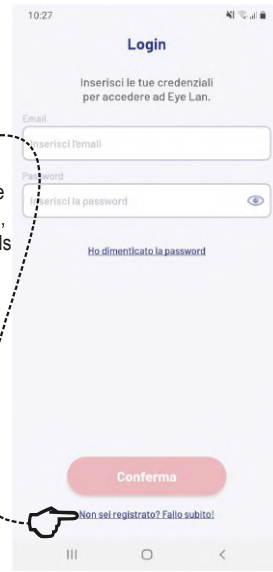

Complete all the required fields; agree with terms and conditions privacy clauses and policy

Click to confirm.

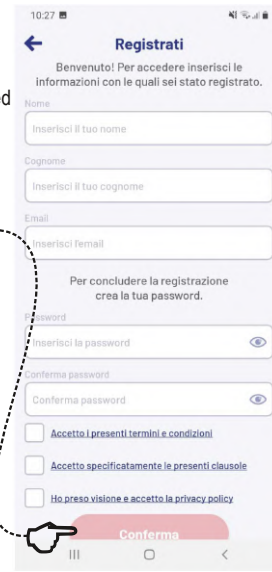

Insert the registered credentials and click to confirm.

Add Qbo.

NOTE: the Qbo terminal must be switched ON correctly linked to the network and with network devices already setted



Scan the QR-code printed on the label on the front plane of the terminal. If the camera is not available, insert manually the serial code: SC1 SC2 SC3 SC4 without spaces between the codes, i.e. 1000000100FEDF, and click ✓



Enter the authentication code in the proper field, which is the ACod parameter from the CodE menu of the terminal

Press Ok

Press on Continue

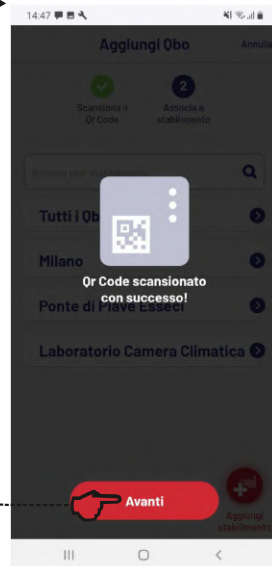

Match the Qbo to an establishment



Create the establishment

Press Add

Then press Go to Home

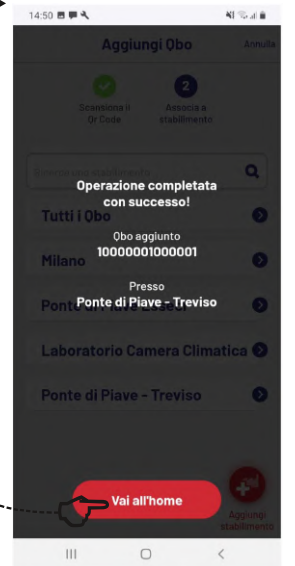

Qbo list

To access the registered Qbo, manage its operation and the relating thermal zones, press here

In presence of more Qbo devices, to select the establishment press here.

For the function "Find Qbo" press here:
now the display and the buzzer of the terminal will turn on intermittently for ab. 10 sec.

Press:

- on the pencil to change the name of the Qbo;
- on the desire thermal zone to access it;
- **Info**: to display Qbo information such as the subscription status;
- **Alarms**: to display current or past alarms in the Qbo terminal;
- **Qbo parameters**: to display and modify the Qbo parameters;
- **User list** to manage the users permissions to access your Qbo.

Thermal zones list

Thermal zone "Mode" window, press:

- on the pencil to change the name of the thermal zone;
- here to change:
 - + the setpoint
 - + the thermal zone mode
- **Alarms**: to display current or past alarms in the Qbo terminal;
- **Operator**: to display and modify the operator parameters in the zone;
- **Zone parameters**: to display and modify the zone parameters;
- **Graph**: to display the last 4 hours trend of the main thermal quantity.

Thermal zone: manual mode

Thermal zone: night mode

Thermal zone: auto mode

To read, insert, delete the thermal zone timer programs click here

Thermal zone: timer program list

To delete a timer program press on the relative bin for example:

To show/hide the day timer programs, if any, press here

To enter a timer program press here

Enter timer program: day(s) selection

Enter time program: mode and time selection

Thermal zone or Qbo: parameter list

Thermal zone: operator list

Press on the pencil or on the cursor of the desired parameter to modify its value.

NOTE: Parameters without pencil or cursor are read-only

Thermal zone or Qbo: parameter value modification

Thermal zone: graph